

# FAST CONNECTOR

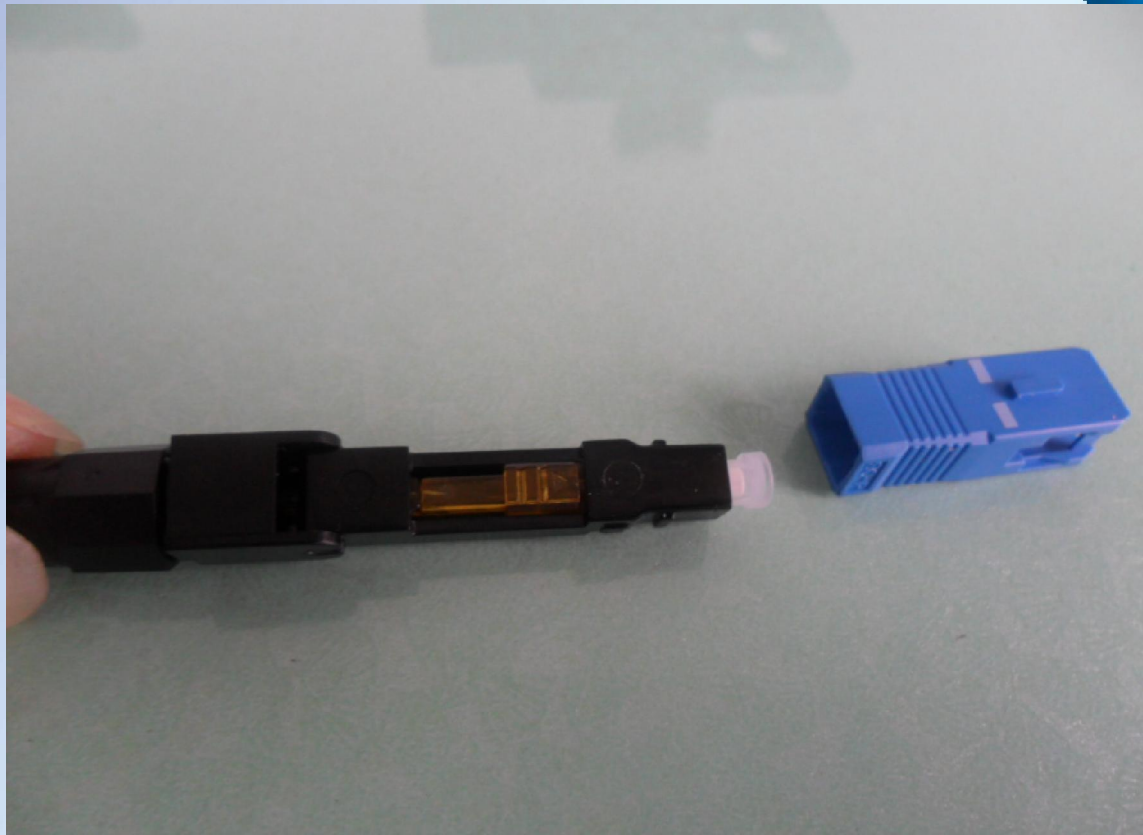

# new pre-embedded fast connector

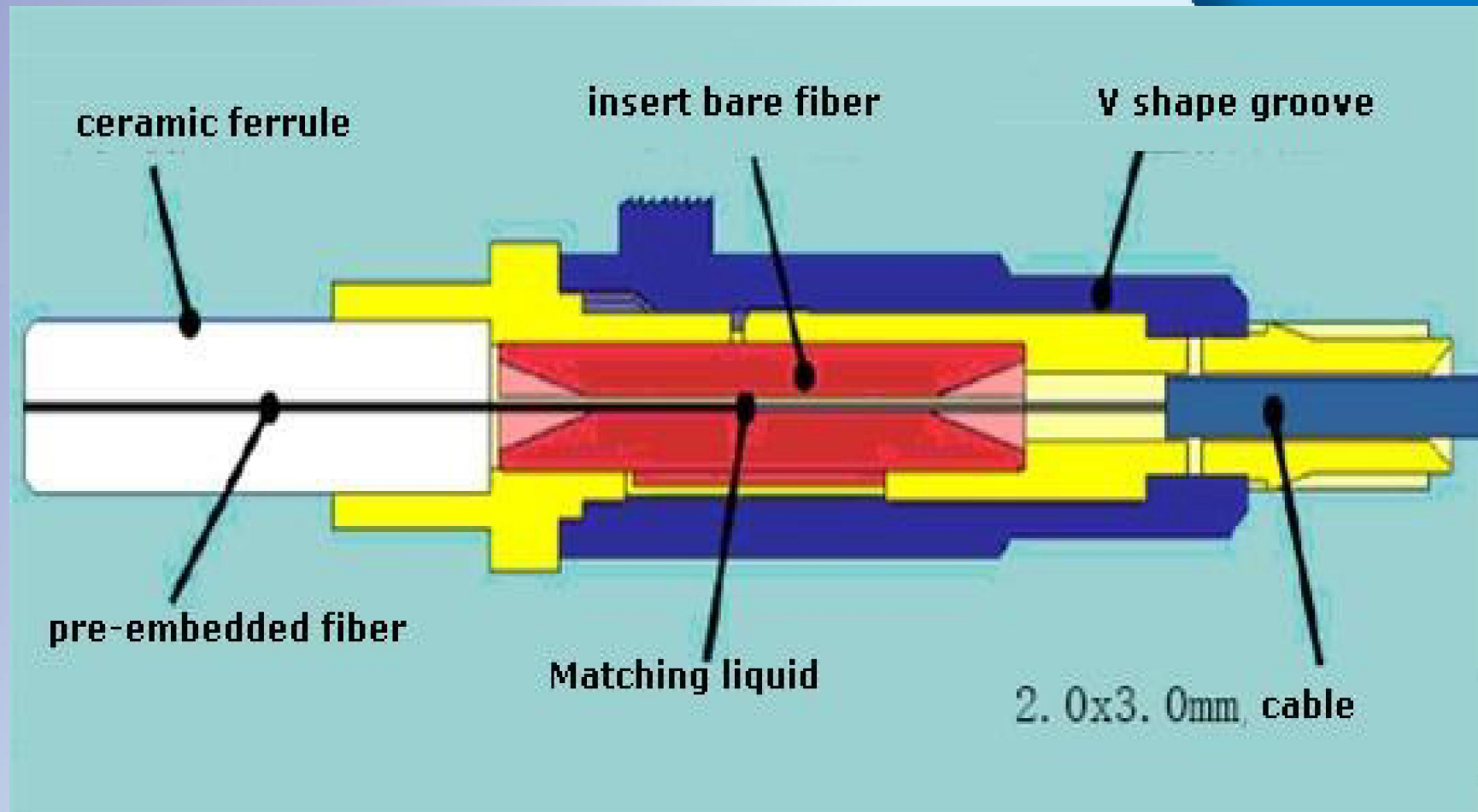

# ***PREPARATION***

---



## **Tools or kits:**

- 1、 Jacket removing tool**
- 2、 Fiber coating stripper**
- 3、 Fiber length measurement**
- 4、 Fiber cleaver**
- 5、 bottle of alcoholic**
- 6、 cleaning tissue**

- **First step: put on boot**



**Put on boot**



- **Second step: Jacket removing tool**

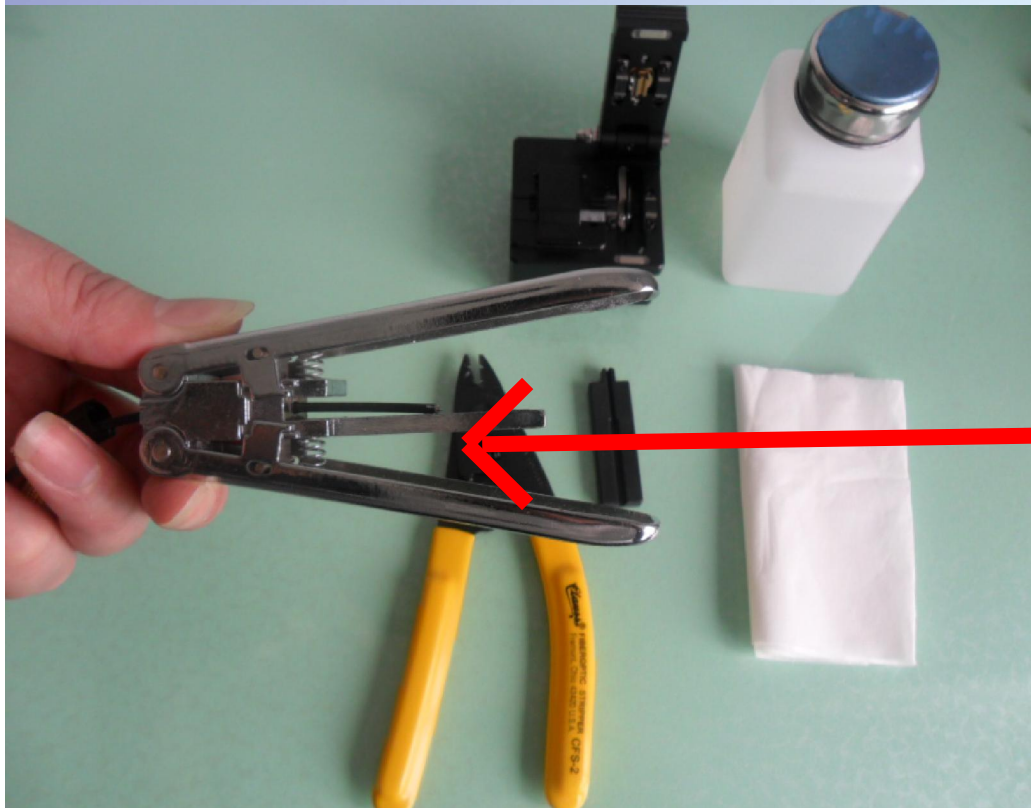

**Fix the cable to  
length 35mm  
and strip the  
jacket**

- **Third step : use jacket removing tool to remove the jacket**



**Press and  
pull out to  
remove the  
jacket**



---

**Fourth step : check the 250U fiber if OK or damage**

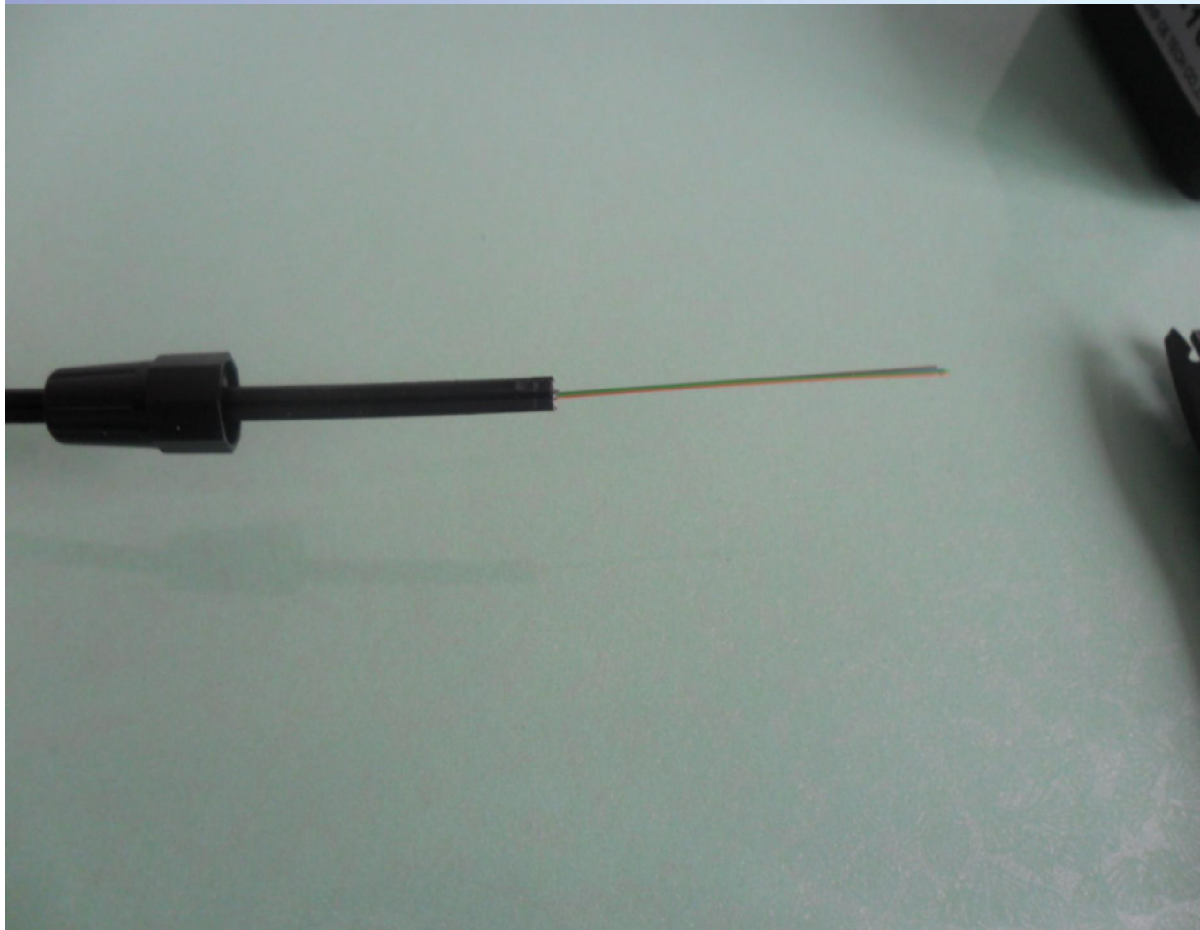

**Flick the fiber with your finger, to check the fiber if complete fine or not**

## OPERATION

- **Fifth step : use coating stripper to strip the coating 25MM, use cleaning tissue and alcohol to clean the bare fiber.**

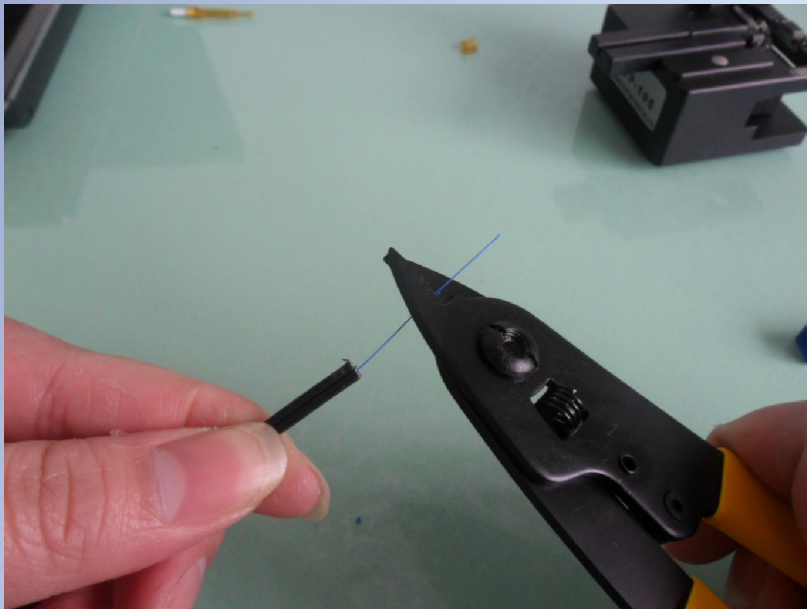

250U fiber length should be: 40mm



## OPERATION

- **Sixth step: fix the bare fiber and use cleaver to cut the bare fiber( take care if the fiber end can be cut**

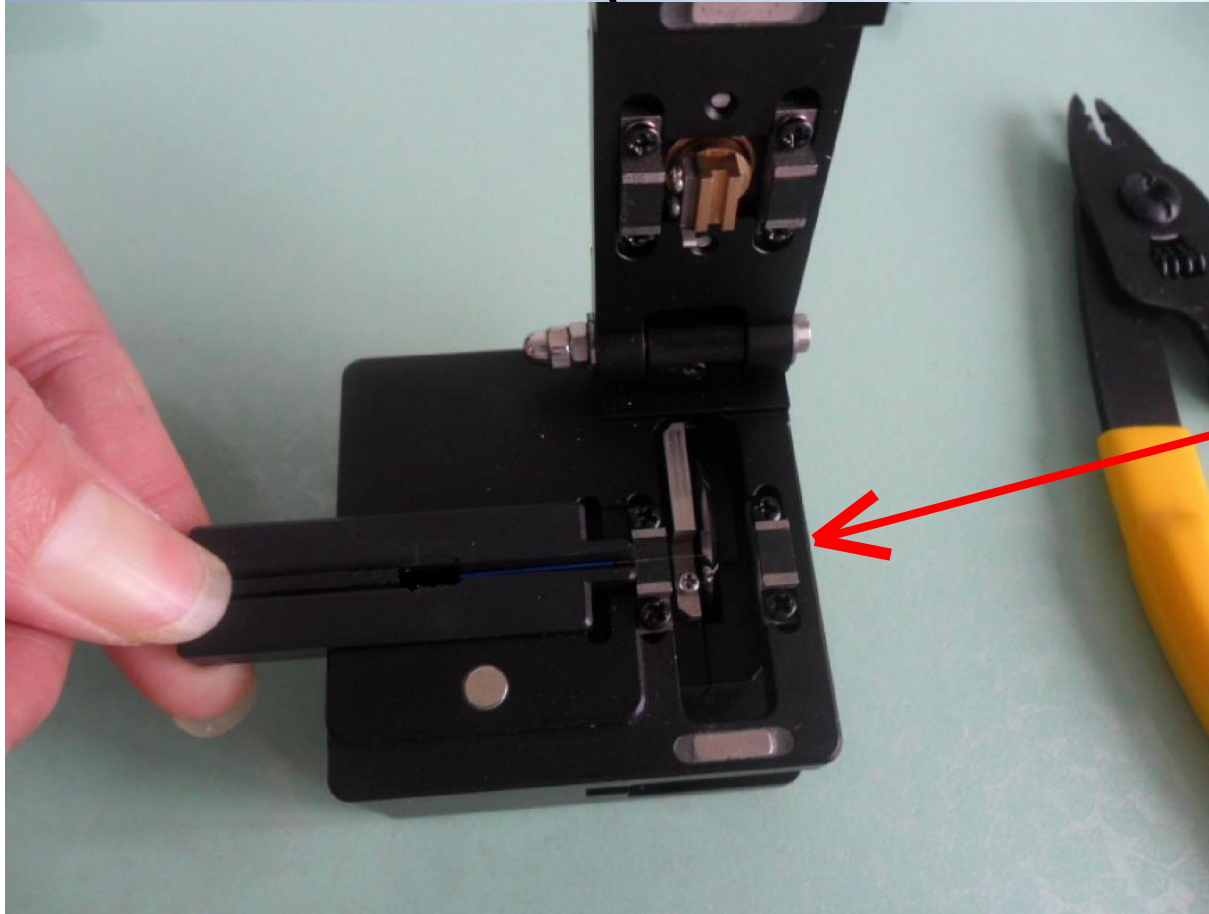

**Be aligned  
cutting**

## OPERATION

- **Seventh step: clean fiber again after cutting**



← **Clean bare  
fiber again**

- **Eighth step: insert fiber to fast connector**

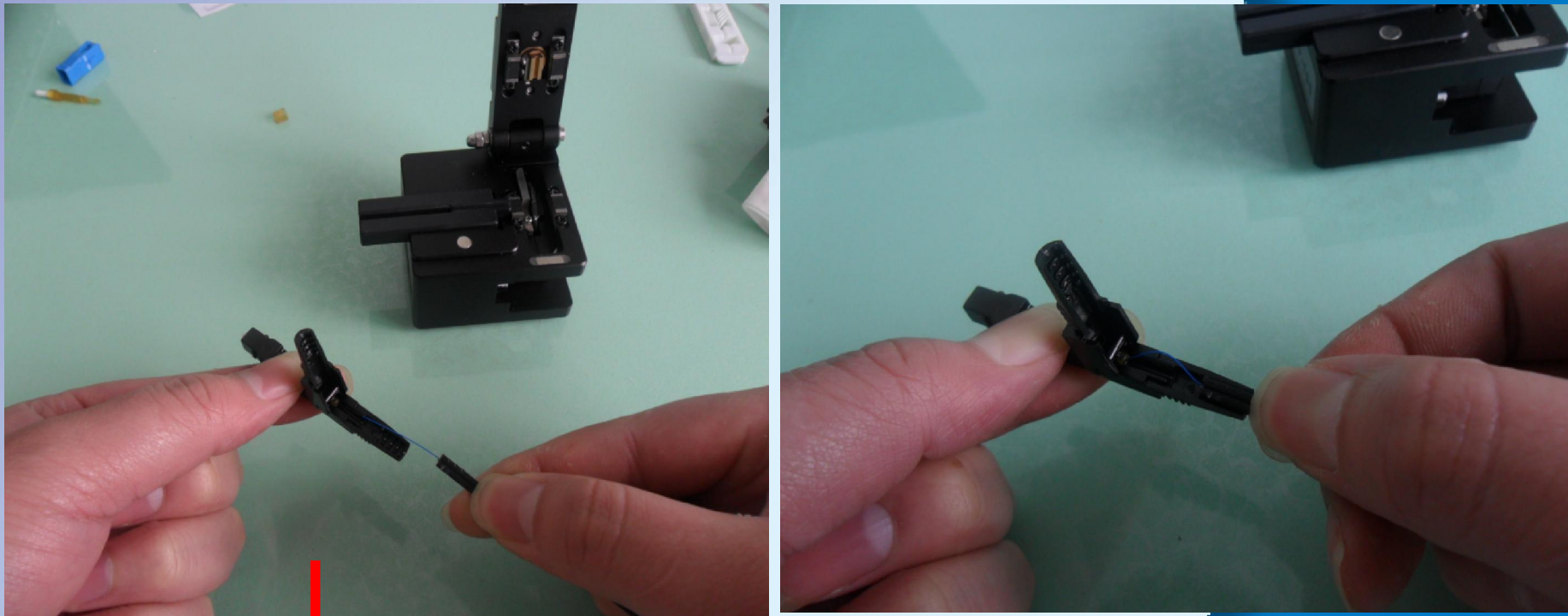

•insert the fiber to the top of pre-embedded fiber ,the fiber will be bending if reach the pre-embedded fiber in the V shape groove, then connect well.

- **Ninth step: fix and lock the fiber in the right position**

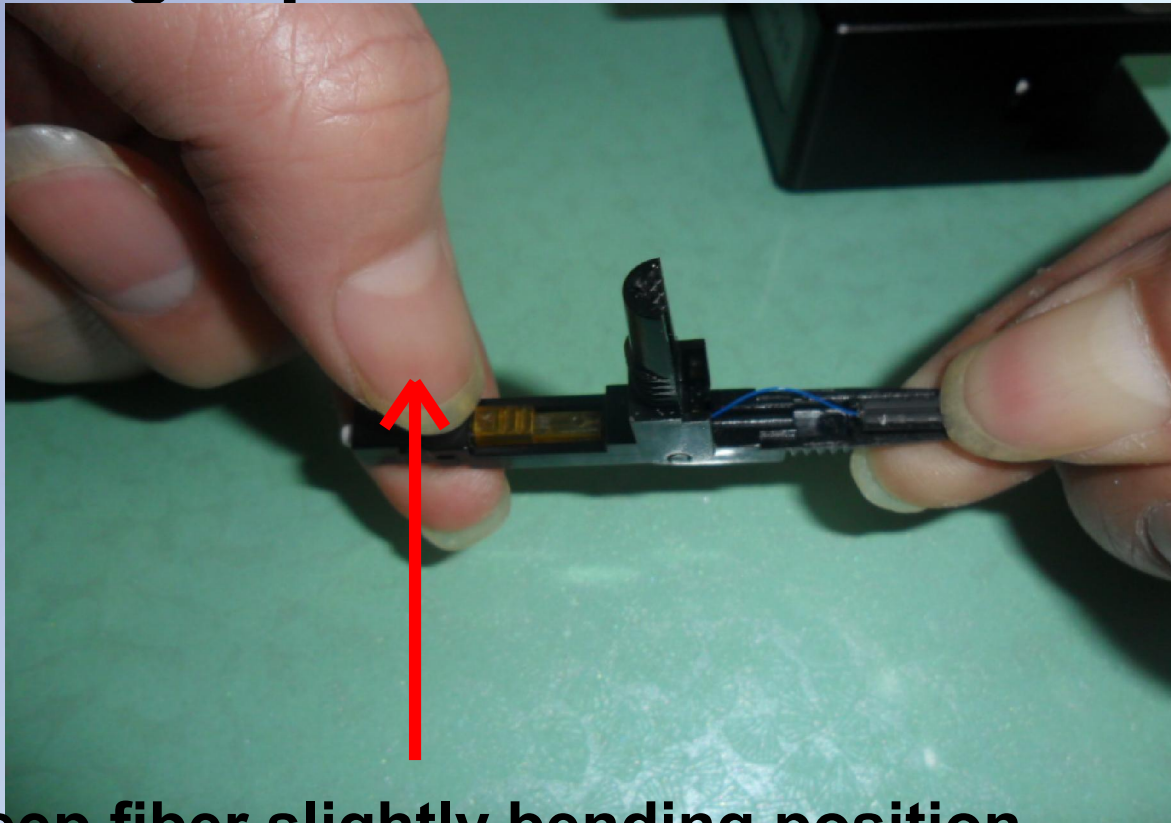

**Keep fiber slightly bending position,  
then push up this button to fix and  
lock the fiber**

## OPERATION

- Tenth step: close the clip to fix the cable, and screw up the boot, put on housing



- Eleventh step: re-use

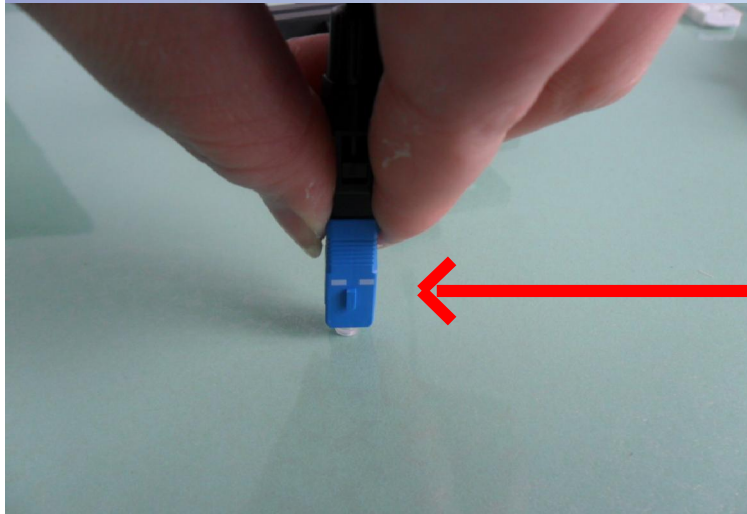

**With dust cap, upside down and move around to move out the housing**

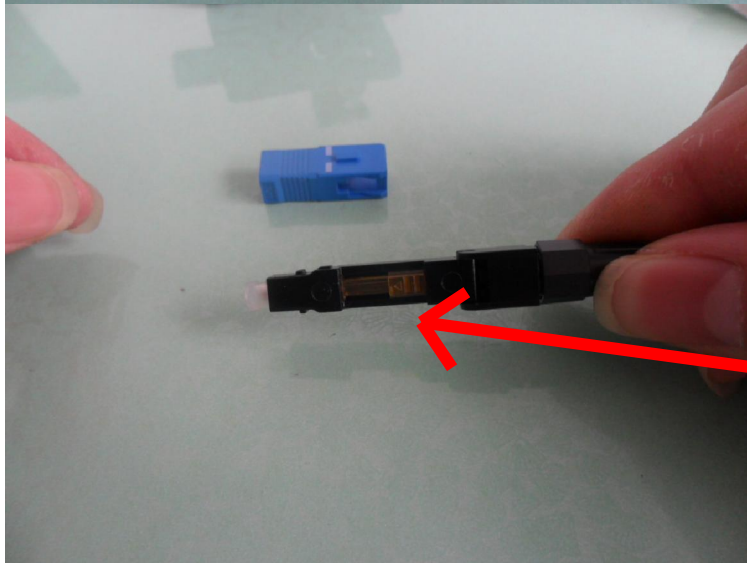

**Push down this button here and pull out the fiber and repeat installation steps**